

KV7-0509

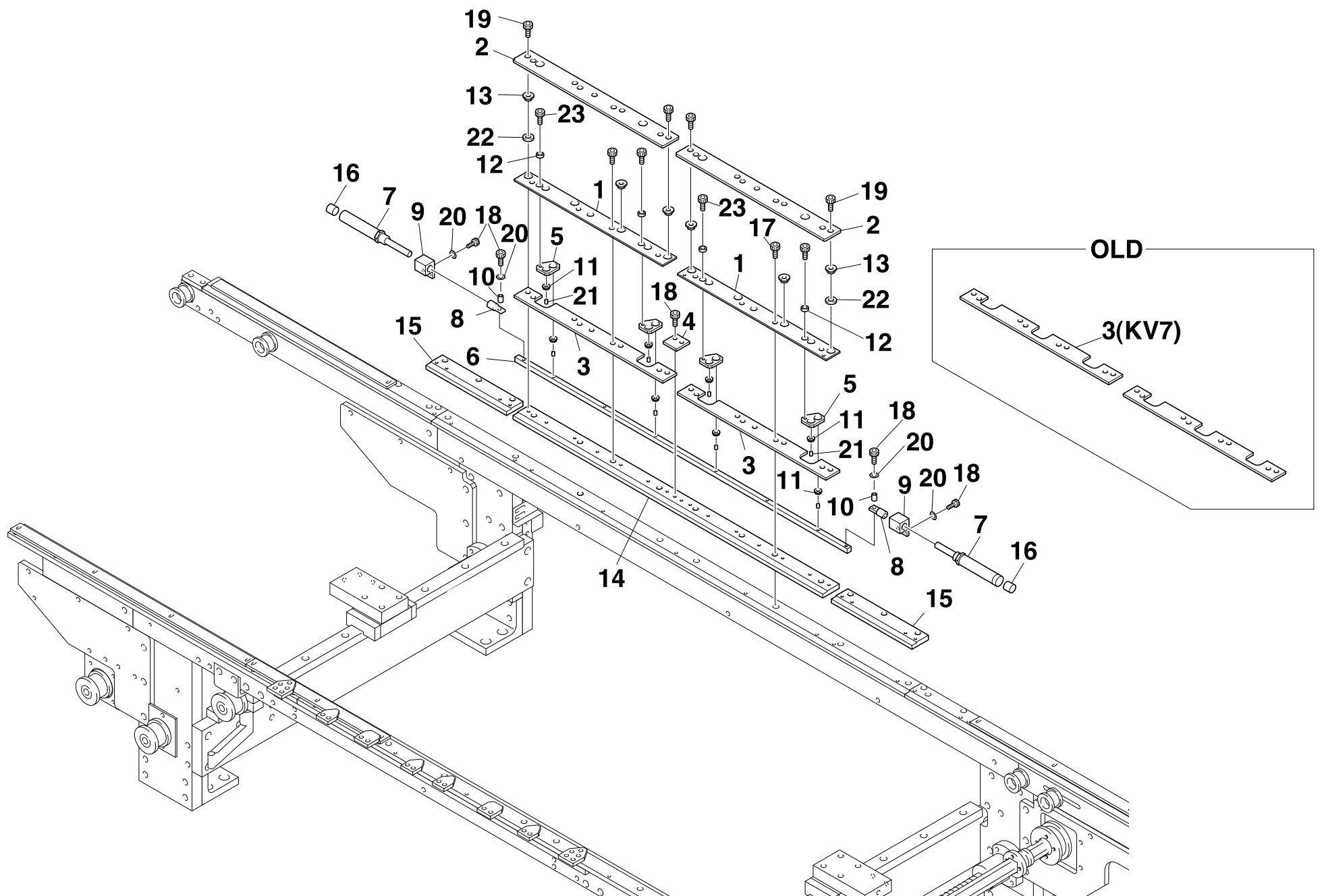

No.	Part No.	Part Name	Q'ty	Remarks	Date of change	Revised No.	Compatibility
1	KV7-M9231-00X	PLATE,EDGE CLAMP	2				
1-1	KV7-M9231-01X	PLATE,EDGE CLAMP	2		1999.08.06	M960025	NG
1-2	KGA-M9231-S0X	PLATE,EDGE CLAMP SET	1		2003.02.22	M250036	NG
2	KV7-M9232-00X	PLATE 3,GUIDE	2				
2-1	KV7-M9232-01X	PLATE 3,GUIDE	2		1999.08.06	M960025	NG
2-2	KV7-M9232-S0X	PLATE 3,GUIDE	1		(2000.07.26)	M070194	OK
2-3	KGA-M9232-S0X	PLATE 3,GUIDE SET	1		2003.02.22	M250036	NG
3	KV7-M9233-00X	GUIDE 2	2				
3-1	KV7-M9233-S0X	GUIDE 2,SET	1		2001.04.13	M000158	OK
3-2	KGA-M9233-S0X	GUIDE 2,SET	1		2003.02.22	M250036	NG
4	KV7-M9234-00X	SPACER,GUIDE	1				
5	KV7-M9235-00X	PLATE,LINK	6				
5-1	KV7-M9235-00X	PLATE,LINK	4	Q'ty change	2003.02.22	M250036	
6	KV7-M9236-00X	SHAFT,LINK	1				
6-1	KV7-M9236-01X	SHAFT,LINK	1		1999.08.06	M960025	NG
6-2	KGA-M9236-10X	SHAFT,LINK	1		2003.02.22	M250036	NG
7	KV7-M9237-00X	CYLINDER PBSA	2	10X5			
8	KV7-M9238-00X	JONIT,CYL.	2				
9	KV7-M9239-00X	BRKT.,CYL.	2				
10	KV7-M923A-00X	COLLAR,JOINT	2				
11	90933-02J084	BRG.	8	MR84ZZ			
12	90933-02J683	BRG.	4	F683ZZS			
13	KV7-M923D-00X	COLLAR,CLAMP PLATE	6				
13-1	KV7-M923D-01X	COLLAR,CLAMP PLATE	6		1999.08.06	M960025	NG
13-2	KV7-M923D-02X	COLLAR,CLAMP PLATE	6		(2002.04.12)	M240056	OK
14	KV7-M9130-00X	GUIDE 2-1	1				
14-1	KV7-M9130-01X	GUIDE 2-1	1		1999.08.06	M960025	NG
14-2	KGA-M9130-10X	GUIDE 2-1	1		2003.02.22	M250036	NG
15	KV7-M9130-10X	GUIDE2-2	2				
16	STSH4-M5M	JOINT	2				
17	91317-03006	BOLT HEX.SOCKET HEAD	18				
18	91317-03008	BOLT HEX.SOCKET HEAD	6				
19	91317-03010	BOLT HEX.SOCKET HEAD	6				
20	92907-03200	WASHER,PLAIN	6				
21	KV7-M923E-00X	PIN ,LINK	8				
22	KU1-M9237-30X	SPACER	6		2003.02.22	M250036	
23	91317-03005	BOLT HEX.SOCKET HEAD	6		(2001.08.31)	M180146	